

Greenway Technical Committee
Meeting Notes
Tuesday, July 14, 2009
Grand Forks Park District Office, 1210-7th Ave. S. Grand Forks, ND
10:30 am- Noon

Marty Egeland, ND Game & Fish
Kristen Benidt, MPO
Teri Kouba, MPO
Gladwin Lynne, RRSRA
Laura Munski, Dakota Science Center
Tom Reiten

LaVonne Nelson, GFPD
Melanie Parvey, City of GF
Dave Aker, EGF Parks & Rec
Troy Schroeder, NWRDC
Kim Greendahl, City of GF

I. Old Business

- a. **2009 Flood cleanup:** Clean up from the spring flood has been completed on both sides of the river. In Grand Forks most facilities did well but some benches and trees were broken by the ice. The trees that were planted along the trail in the Sunbeam area with the Xcel Foundation project in May have sprung back and are growing well. Less than fifteen of those had to be replanted.
- b. **Trail signage and mile markers:** Melanie is still working with the consultants, LA Group, to finalize a plan for the trail markers. A copy of the proposed marker signs was distributed to the group for input. Once a design plan is finalized staff can begin to seek funding to implement the plan.
- c. **Way finding sign plan:** Several years ago a way finding sign plan directing visitors to the downtown area was developed by the Metropolitan Planning Organization (MPO) but was not put into action. The plan concentrated on downtown but could be modified to include the Greenway. Melanie will work with Teri to review the plan that was approved by both city councils to determine if parts of it can be implemented for the Greenway when funding is available.
- d. **MPO Transportation Plan/bike & pedestrian portion:** The MPO is updating the bike and pedestrian portion of the Transportation Plan. Trail use survey has been completed and includes an ADA curb study to determine compliance. Kristen would like input on the goals, objectives and standards section of the plan. Please review and send any suggestions to Kristen at mpointern@yahoo.com. Deadline for input is the end of September. The draft plan should be ready by the end of December then it will begin the approval process with MPO Board and both councils. Public hearings will be a part of the process too.

II. New Business

- a. **Next meeting date:** This has been rescheduled to Tuesday, September 15 because of the Labor Day holiday.

III. Greenway Agency Updates

- a. **City of EGF:** Work has begun to add 22 new campsites to the RRSRA. This will bring the total sites to 98. A loan program for fishing equipment and binoculars at the campground was started this season.
- b. **City of GF:** Events and races have been very popular this year. There should be a lull in large races now until early fall.
- c. **GF Park District:** No report
- d. **MN DNR:** No report
- e. **NWRDC:** Funding was receiving for a two year project to work on regional trail plan in the seven counties of NW Minnesota. There will be a public meeting in East Grand Forks later this summer to get input on what trails are out there and what user groups are working on.

- f. **Dakota Science Center:** Laura is working on an activity for local teachers this summer to develop a way finding GPS plan that encourages finding specific educational sites within the Greenway.

IV. Next Greenway Technical Committee meeting: September 15, 2009 – 10:30 am at Grand Forks Park District, 1210 7th Avenue South

V. Adjournment

Submitted by: Kim Greendahl, Greenway Specialist, City of Grand Forks

Grand Forks Greenway Proposed Trail Marker Plan

Existing Signage



Street Access

Greenway Access

Tall Posts

Park Access

Entry Kiosk

Adopt-a-Trail

Existing Trail Signs:

- Street and Outside Park Access from City
- Tall Posts marking park amenities
- Entry Kiosk Inside/Outside Greenway
- Adopt-a-Trail
- Greenway Signs Outside Levee

Existing Trail Signs to be Eliminated:

- Street Access
- Adopt-a-Trail
- Existing Signs to Remain:
- Greenway Access
- Entry Kiosk
- Tall Posts

Proposed Trail Signs:

Three Sign Types:

- Large – using existing tall poles
- Street Access Points/City Bike Route Connection
- Linear Access Indicator
- Small – Timber post example
- Trail Color Indication/Next Access Point
- No Motorized Vehicles/Adopt-a-Trail/Keep Left/Right
- 911 Location No.
- "Y" /Spur Trail
- Timber post example
- Distance to re-connection to main trail w/graphic

Additional Recommendations:

- Make Full Greenway map available at each park site

Small – Timber Post

Large/Tall Posts

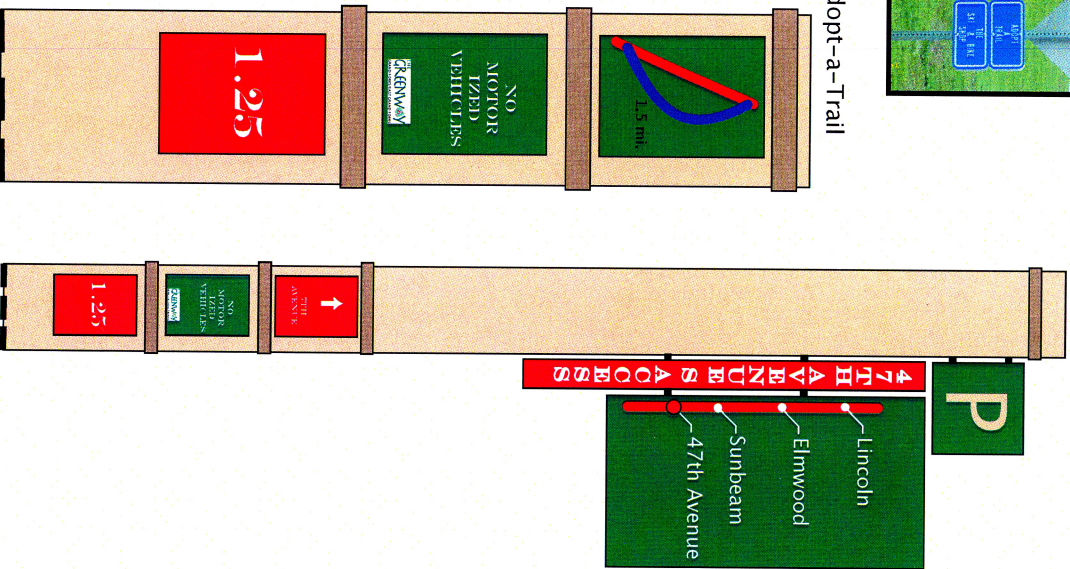

Design firm:
The LA Group
 14 Roberts St, Ste. 400
 Fargo, ND 58102

Project Title:
 Grand Forks Greenway
 Trail Marker System

Grand Forks Greenway Trail Marker System

Client:	Notre Dame
Project Name:	Grand Forks Greenway Trail Marker System
Project Number:	1.1
Scale:	As Shown
Author:	JL
Check:	JL
Drawn:	JL
Scale:	As Shown
Sheet Title:	Schematic
Drawing No.:	1.1

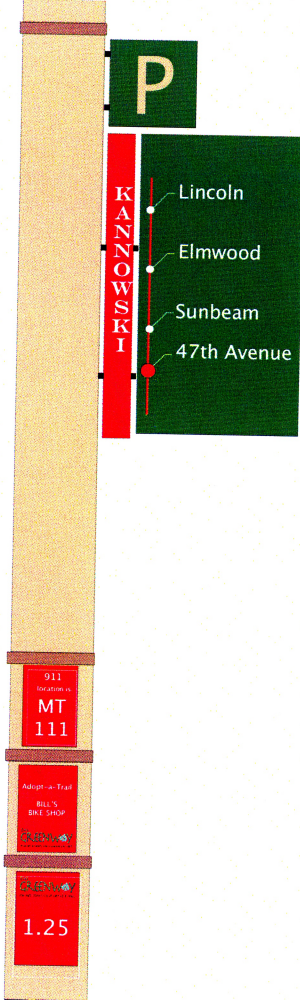
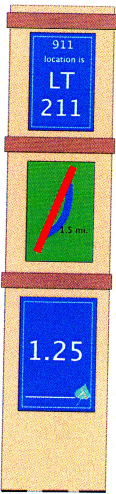
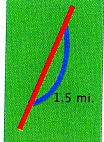
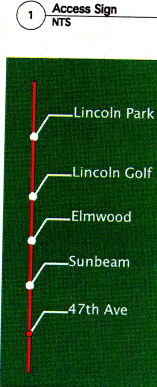
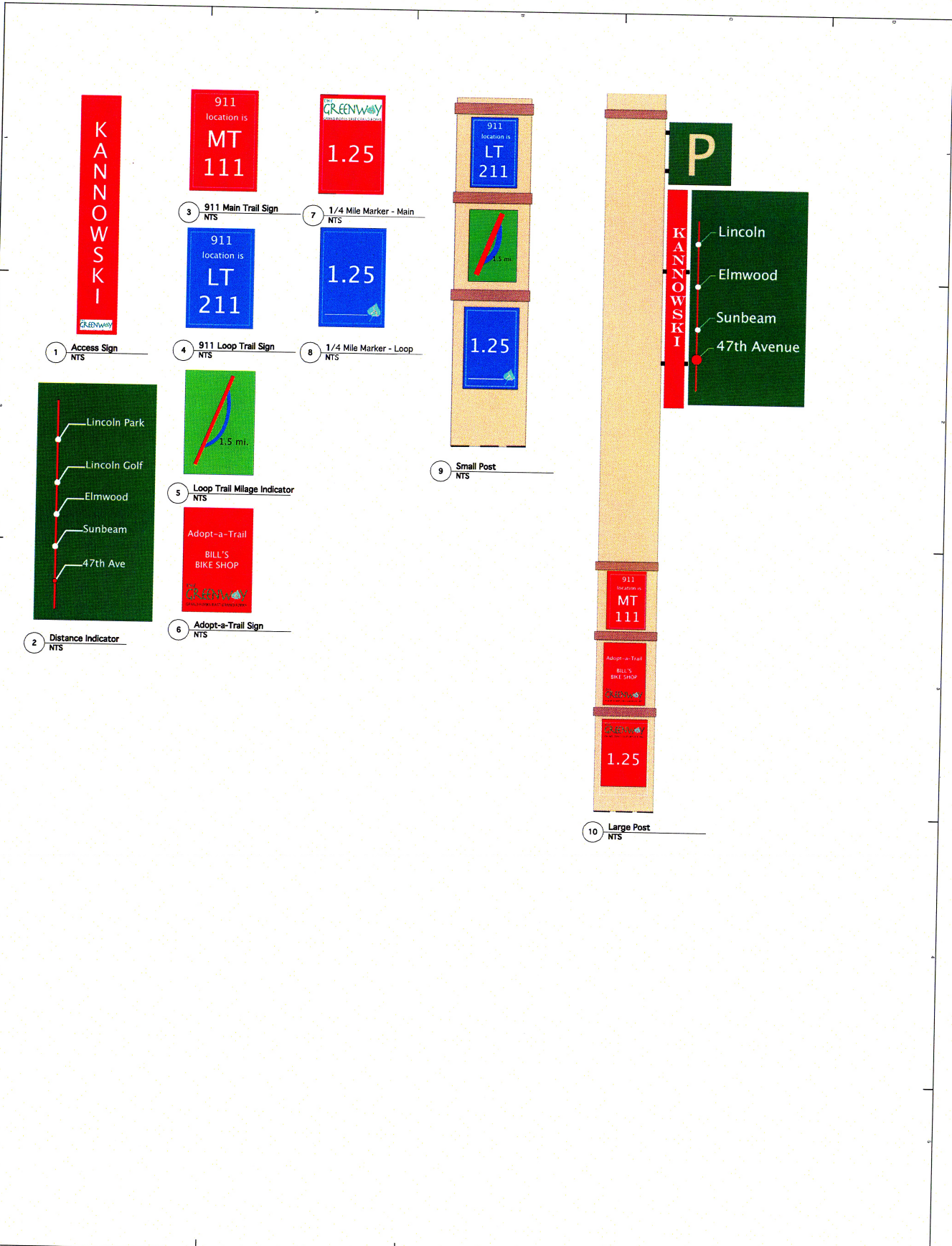

Project Name	Greenway Trail Marker System
Client	City of Grand Forks
Project Number	LA-2018-001
Revision	01
Scale	As Shown
Date	10/26/2018
Author	JL
Checker	JL
Appr. Authority	JL
Appr. Title	City Engineer

NOT A CONSTRUCTION DOCUMENT

Greenway Trail Marker System

Grand Forks, ND

The LA Group
1400 West 15th Street
Grand Forks, ND 58201
701.775.1111

Project Name: _____
Sheet No: _____